

Microstop Cages   RB 156 .....	51
Microstop Cages   RB 206, RBI 206 .....	52
Microstop Cages   RB 256, RBI 256 .....	54
Ball-Type Microstop Cages   RB 257 .....	56
Ball-Type Microstop Cages   RB 258, RBI 258 .....	58
Microstop Cages   RB 306 - Large Window .....	60
Microstop Cages   RB 306 - Small Window .....	61
Ball-Type Microstop Cages   RB 307, RBI 307 - Large Window .....	62
Ball-Type Microstop Cages   RB 307, RBI 307 - Small Window .....	63
Microstop Cages   RB 356 HP 21, RBI 356 HPI 21 - Large Window ---	64
Microstop Cages   RB 356 HP 21, RBI 356 HPI 21 - Small Window ---	65
Microstop Cages   RB 356 HP38, RBI 356 HPI 38 - Large Window ----	66
Microstop Cages   RB 356 HP38, RBI 356 HPI 38 - Small Window ----	67
Microstop Cages   RB 356 HP58, RBI 356 HPI 58 .....	68
Microstop Cages   RB 406 .....	70
Drill Holder   For Use with Microstop Cages .....	72

**RB 156**



**RB 256**



**RB 406**



**RB 356 HP 38**



MICROSTOP CAGE	SHANK DIA.	CUTTER THREAD	STROKE	Ø EXT. MAXI	TOTAL LENGTH	
					MINI	MAXI
<b>RB 156</b>	Ø 4.8 mm - 0.19 in dia	M6 x 1	3.5 mm - 0.14 in	Ø 25 mm - 1 in dia	51 mm - 2 in	55 mm - 2.16 in
<b>RB 206</b>	Ø 6 mm - 0.24 in dia	M6 x 1	6 mm - 0.24 in	Ø 21 mm - 0.826 in dia	95 mm - 3.74 in	101 mm - 3.97 in
<b>RBI 206</b>	Ø 6 mm - 0.24 in dia	1/4 in - 28 F	6 mm - 0.24 in	Ø 21 mm - 0.826 in dia	95 mm - 3.74 in	101 mm - 3.97 in
<b>RB 256</b>	Ø 6 mm - 0.24 in dia	M6 x 1	7.5 mm - 0.3 in	Ø 28 mm - 1.1 in dia	91 mm - 3.58 in	98 mm - 3.85 in
<b>RBI 256</b>	Ø 6 mm - 0.24 in dia	1/4 in - 28 F	7.5 mm - 0.3 in	Ø 28 mm - 1.1 in dia	91 mm - 3.58 in	98 mm - 3.85 in
<b>RB 257</b>	Ø 6 mm - 0.24 in dia	M6 x 1	6 mm - 0.24 in	Ø 29 mm - 1.14 in dia	88 mm - 3.46 in	92 mm - 3.62 in
<b>RB 258</b>	Ø 6.35 mm - 1/4 in dia	M6 x 1	27 mm - 1.06 in	Ø 29 mm - 1.14 in dia	141 mm - 5.55 in	156 mm - 6.14 in
<b>RBI 258</b>	Ø 6.35 mm - 1/4 in dia	1/4 in - 28 F	27 mm - 1.06 in	Ø 29 mm - 1.14 in dia	141 mm - 5.55 in	156 mm - 6.14 in
<b>RB 306</b>	Ø 6 mm - 0.24 in dia	M8 x 1	7.5 mm - 0.3 in	Ø 28 mm - 1.1 in dia	91 mm - 3.58 in	98 mm - 3.85 in
<b>RB 307</b>	Ø 6 mm - 0.24 in dia	M8 x 1	7 mm - 0.28 in	Ø 29 mm - 1.14 in dia	88 mm - 3.46 in	98 mm - 3.62 in
<b>RBI 307</b>	Ø 6 mm - 0.24 in dia	1/4 in - 28 F	7 mm - 0.28 in	Ø 29 mm - 1.14 in dia	88 mm - 3.46 in	98 mm - 3.62 in
<b>RB 406</b>	Ø 6 mm - 0.24 in dia / JTI	M10 x 1	14 mm - 0.55 in	Ø 36 mm - 1.42 in dia	136 mm - 5.35 in	163 mm - 6.42 in
<b>RB 356 HP 21</b>	Ø 6 mm - 0.24 in dia / JTI	M6 x 1	21 mm - 0.83 in	Ø 27 mm - 1.06 in dia	116 mm - 4.57 in	136 mm - 5.35 in
<b>RB 356 HPI 21</b>	Ø 6 mm - 0.24 in dia / JTI	1/4 in - 28 F	21 mm - 0.83 in	Ø 27 mm - 1.06 in dia	116 mm - 4.57 in	136 mm - 5.35 in
<b>RB 356 HP 38</b>	Ø 6 mm - 0.24 in dia / JTI	M6 x 1	38 mm - 1.5 in	Ø 27 mm - 1.06 in dia	183 mm - 7.2 in	168 mm - 6.61 in
<b>RB 356 HPI 38</b>	Ø 6 mm - 0.24 in dia / JTI	1/4 in - 28 F	38 mm - 1.5 in	Ø 27 mm - 1.06 in dia	183 mm - 7.2 in	168 mm - 6.61 in
<b>RB 356 HP 58</b>	Ø 6 mm - 0.24 in dia / JTI	M10 x 1	58 mm - 2.28 in	Ø 38 mm - 1.5 in dia	264 mm - 10.4 in	292 mm - 11.5 in
<b>RB 356 HPI 58</b>	Ø 6 mm - 0.24 in dia / JTI	7/16 in - 20 F	58 mm - 2.28 in	Ø 38 mm - 1.5 in dia	264 mm - 10.4 in	292 mm - 11.5 in

# Microstop Cages for Hand Drilling Tools

RB 156

**Recoles  
Quackenbush®**  
Precision Drilling-Every Time

## ADVANTAGES

- Different mounting bases available.
- Reduced dimensions for tight access areas.
- For special composites → mounting base with vacuum.

## PRECISION MANUFACTURING

- Cemented, hardened, and ground chrome-nickel steel spindle mounted on a self-lubricating bronze body and a thrust bearing.
- Centering cone of the cutter (120°) for perfect concentricity.
- Microstop depth adjustment (1 scale division = 0.001 in).
- Microstop depth setting is held securely in place by locknut with seal. This patented feature allows an easy loosening of the locknut without damage to the drill cage.

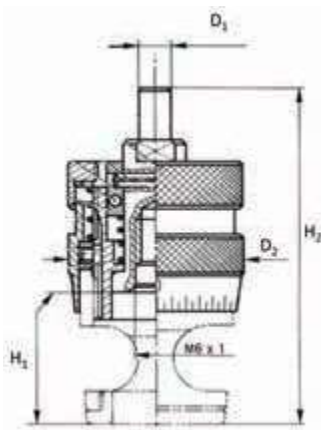

Dimensions for large and small window

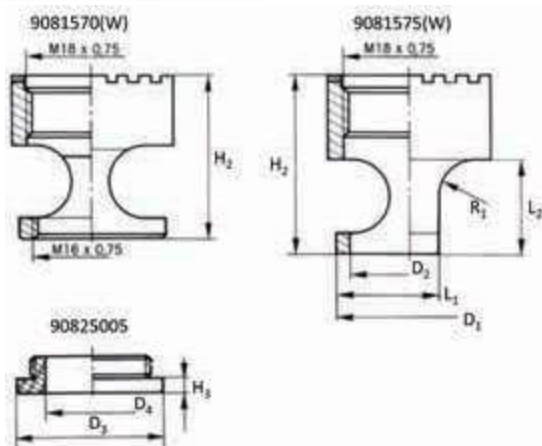

Basic Drill Cage



MICROSTOP CAGE									
RB 156	T		D1	D2	H1		H2		Stroke
	M6 x 1				Min	Max	Min	Max	
		mm	4.8	25	20	24	51	55	
		in	0.19	0.98	0.79	0.94	2.01	2.17	

MOUNTING BASE								
		D1	D2	L1	L2	H2	R1	D6
90815170(W)	mm	NA	NA	NA	NA	22	NA	NA
	in	NA	NA	NA	NA	0.87	NA	NA
9081575(W)	mm	20	16	14	13	24	13	NA
	in	0.79	0.63	0.55	0.51	0.94	0.51	NA

NOSE PIECE				
		D3	D4	H3
90825005	mm	20	12.5	2
	in	0.79	0.49	0.08

RB 156		MICROSTOP CAGE ASSEMBLY CODE			
		10000010	10000010W	10000100	10000100W
Basic Drill Cage		●	●	●	●
Tapped Mounting Base	90815170	●			
Tapped Mounting Base Large Window	90815170W		●		
Offset Mounting Base	90815175			●	
Offset Mounting Base Large Window	90815175W				●
Nylon Nose Piece	90825005	●	●		

## Microstop Cages for Hand Drilling Tools

RB 206 | RBI 206

**Recoles  
Quackenbush®**  
Precision Drilling - Every Time

### ADVANTAGES

- Different mounting bases available.
- Reduced dimensions for tight access areas.
- For special composites → mounting base with vacuum.

### PRECISION MANUFACTURING

- Cemented, hardened, and ground chrome-nickel steel spindle mounted on a self-lubricating bronze body and thrust bearing.
  - Centering cone of the cutter (120°) for perfect concentricity.
  - Microstop depth adjustment (1 scale division = 0.001 in).
  - Microstop depth setting is held securely in place by locknut with seal.
- This patented feature allows an easy loosening of the locknut without damage to the drill cage.



RB 206		MICROSTOP CAGE ASSEMBLY CODE									
		10005000W	10005000	10005200W	10005200	10005305W	10005305	10005001W	10005001	10005306W	10005306
RBI 206		10005050W	10005050	10005250W	10005250	10005355W	10005355	10005051W	10005051	10005356W	10005356
Basic Drill Cage		•	•	•	•	•	•	•	•	•	•
Mounting Base Flat Bearing Large Window	90815005W	•									
Mounting Base Flat Bearing	90815005		•								
Offset Mounting Base Large Window	90815015W			•							
Offset Mounting Base	90815015				•						
Tapped Mounting Base Large Window	90815020W					•					
Tapped Mounting Base	90815020						•				
Mounting Base Flat Bearing Large Window w/ Vacuum	90815003W							•			
Mounting Base Flat Bearing With Vacuum	90815003								•		
Tapped Mounting Base Large Window w/ Vacuum	90815018W									•	
Tapped Mounting Base w/ Vacuum	90815018										•
Nylon Nose Piece	90825005					•	•			•	•

Microstop Cages for Hand Drilling Tools

RB 206 | RBI 206

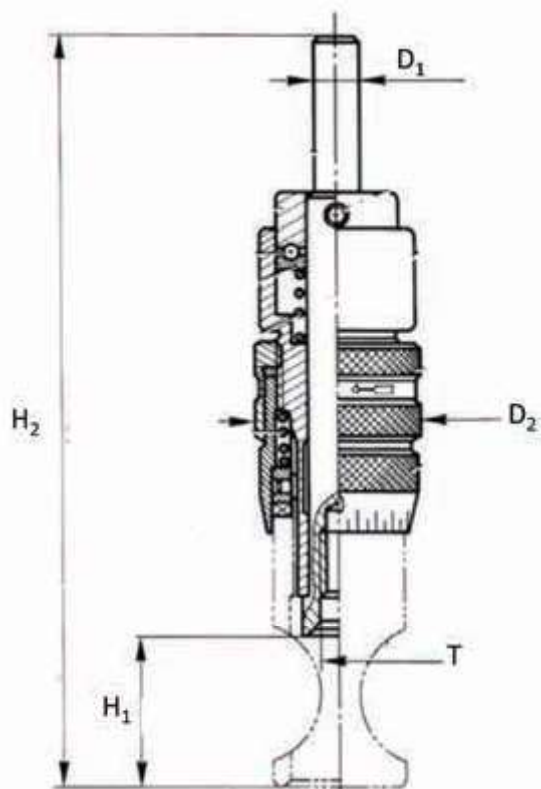

MICROSTOP CAGE									
					H1		H2		Stroke
	T		D1	D2	Min	Max	Min	Max	
RB 206	M6 x 1	mm	6	21	19	25	95	101	6
RBI 206	1/4 in - 28	in	0.24	0.83	0.75	0.98	3.74	3.98	0.24

MOUNTING BASE								
		D1	D2	L1	L2	H2	R1	D6
90815005(W)	mm	17	12.5	NA	NA	35	NA	NA
	in	0.67	0.49	NA	NA	1.38	NA	NA
90815015(W)	mm	17	12.5	11	19	35	8	NA
	in	0.67	0.49	0.43	0.75	1.38	0.31	NA
90815020(W)	mm	20	NA	NA	NA	33	NA	NA
	in	0.79	NA	NA	NA	1.30	NA	NA
90815003(W)	mm	17	12.5	NA	NA	35	NA	16
	in	0.67	0.49	NA	NA	1.38	NA	0.63
90815018(W)	mm	20	NA	NA	NA	34	NA	16
	in	0.79	NA	NA	NA	1.34	NA	0.63

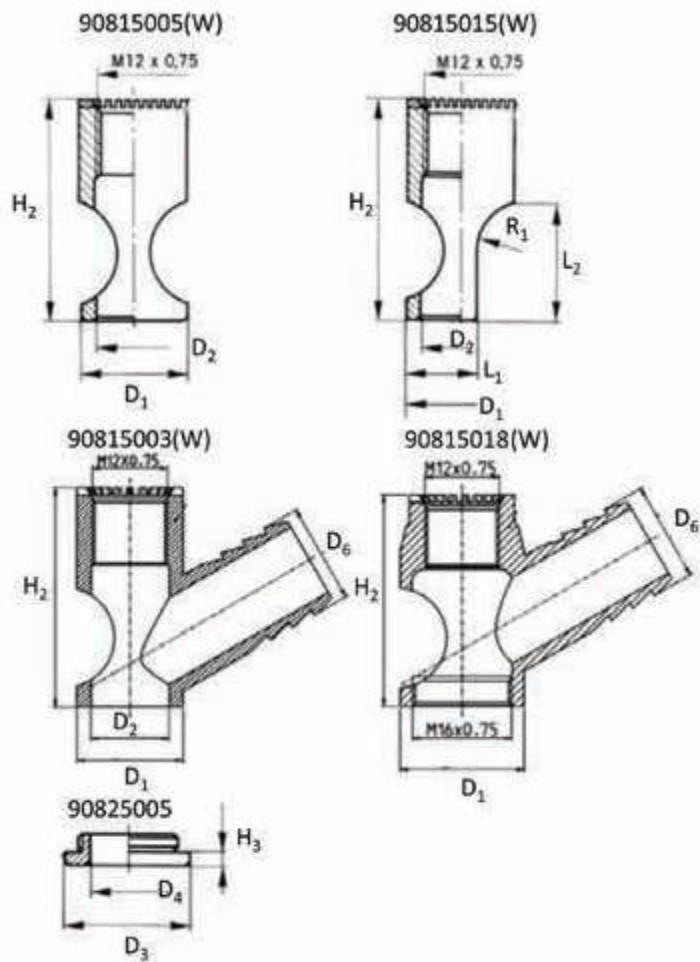

Dimensions for  
large and small window

NOSE PIECE				
		D3	D4	H3
90825005	mm	20	12.5	2
	in	0.79	0.49	0.08

## Microstop Cages for Hand Drilling Tools

RB 256 | RBI 256

**Recoules  
Quackenbush®**  
Precision Drilling - Every Time

### ADVANTAGES

- Different mounting bases available
- Reduced dimensions for tight access areas
- For special composites → mounting base with vacuum.

### PRECISION MANUFACTURING

- Cemented, hardened, and ground chrome-nickel steel spindle mounted on a self-lubricating bronze body and a thrust bearing.
  - Centering cone of the cutter (120°) for perfect concentricity.
  - Microstop depth adjustment (1 scale division = 0.001 in).
  - Microstop depth setting is held securely in place by locknut with seal.
- This patented feature allows an easy loosening of the locknut without damage to the drill cage.



RB 256		MICROSTOP CAGE ASSEMBLY CODE									
		10010010W	10010010	10010015W	10010015	10010001W	10010001	10010016W	10010016	10010205W	10010205
RBI 256		10010110W	10010110	10010115W	10010115	10010111W	10010111	10010116W	10010116		
Basic Drill Cage		•	•	•	•	•	•	•	•	•	•
Tapped Mounting Base Large Window	90815060W	•		•							
Tapped Mounting Base	90815060		•		•						
Tapped Mounting Base Large Window w/ Vacuum	90815063W					•		•			
Tapped Mounting Base w/ Vacuum	90815063						•		•		
Threaded Mounting Base Large Window w/ Vacuum	90815098W									•	
Threaded Mounting Base w/ Vacuum	90815098										•
Hard Chrome Steel Nose	90825015	•	•			•	•				
Nylon Nose Piece	90825020			•	•			•	•		
Nylon Nose Piece	90825085									•	•



## Microstop Cages for Hand Drilling Tools

RB 256 | RBI 256

**Recoles  
Quackenbush®**  
Precision Drilling-Every Time

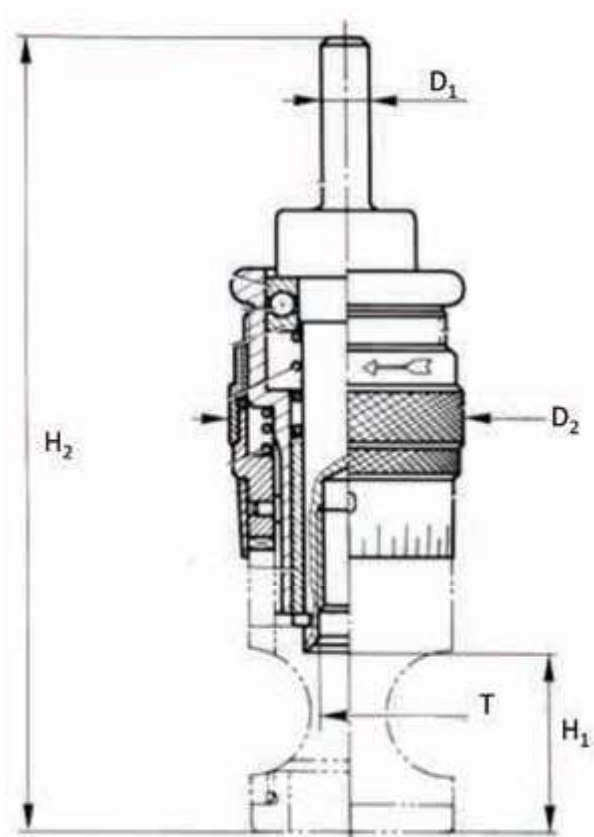

MICROSTOP CAGE									
					H1		H2		Stroke
	T		D1	D2	Min	Max	Min	Max	
RB 256	M6 x 1	mm	6	28	19	26	91	98	7.5
RBI 256	1/4 in - 28	in	0.24	1.10	0.75	1.02	3.58	3.86	0.30

MOUNTING BASE								
		D1	D2	L1	L2	H2	R1	D6
90815060(W)	mm	NA	NA	NA	NA	32	NA	NA
	in	NA	NA	NA	NA	1.26	NA	NA
90815063(W)	mm	24	NA	NA	NA	32	NA	16
	in	0.94	NA	NA	NA	1.26	NA	0.63
90815098(W)	mm	NA	26	NA	NA	32	NA	16
	in	NA	1.02	NA	NA	1.26	NA	0.63

NOSE PIECE				
		D3	D4	H3
90825015	mm	24	15	3
	in	0.94	0.59	0.12
90825020	mm	24	15	3
	in	0.94	0.59	0.12
90825085	mm	36	26	3
	in	1.42	1.02	0.12

Dimensions for  
large and small window

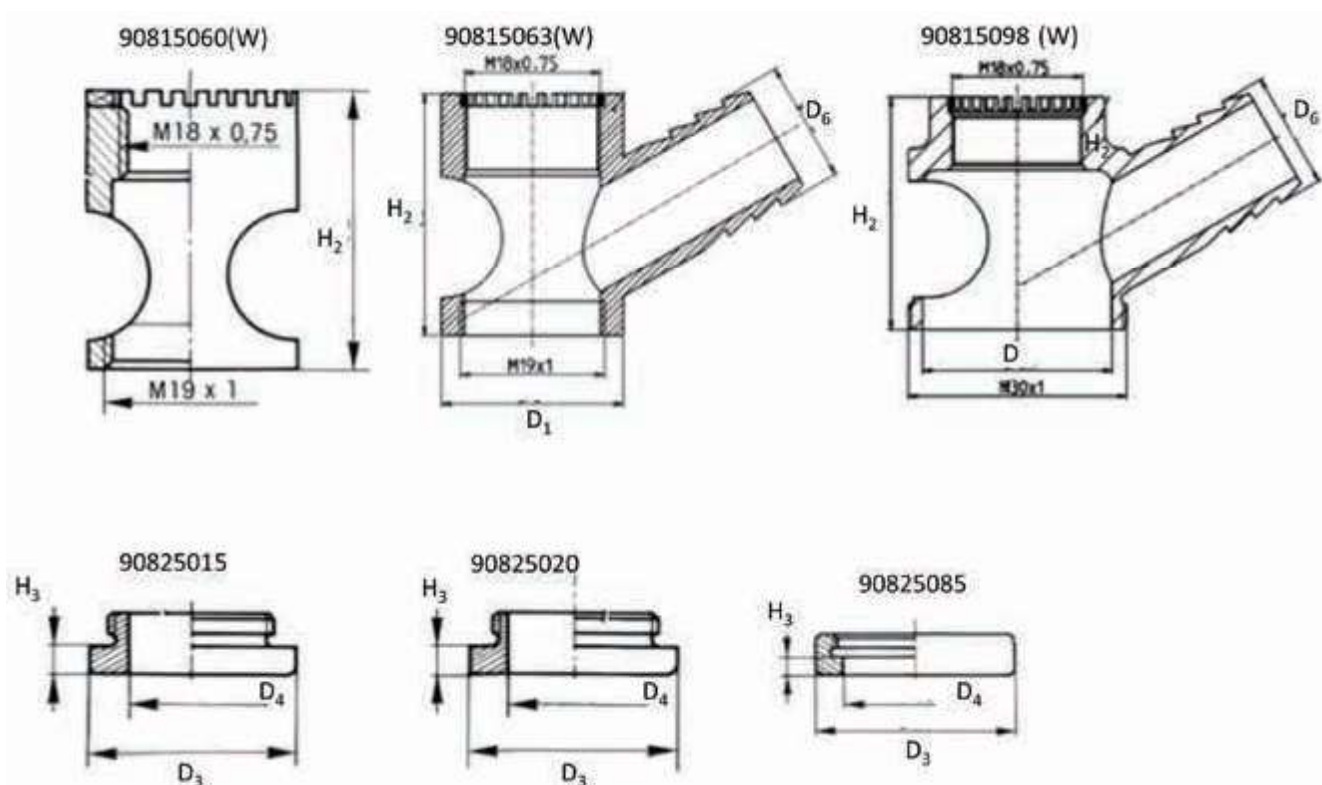

# Ball-Type Microstop Cages for Hand Drilling Tools

RB 257

**Recoules  
Quackenbush®**  
Precision Drilling - Every Time

## ADVANTAGES

- Different mounting bases available.
- Reduced dimensions for tight access areas.
- For special composites → mounting base with vacuum.

## PRECISION MANUFACTURING

- High precision microstop cage, body in heat-treated chrome steel, fully ground throughout. This ball-mounted microstop cage includes two needle bearings for best utilization.
- When using the RB 257, any misalignment of the microstop cage is corrected by the unique ball-pivoting spindle. This assembly ensures perpendicularity throughout the operation at all time.
- Centering cone of the cutter (120°) for perfect concentricity.
- Microstop depth adjustment (1 scale division = 0.001 in).
- Microstop depth setting is held securely in place by locknut with seal. This patented feature allows an easy loosening of the locknut without damage to the drill cage.



RB 257		MICROSTOP CAGE ASSEMBLY CODE													
		10015010W	10015010	10015015W	10015015	RC-10015020W	RC-10015020	10015200W	10015200	10015001W	10015001	10015016W	10015016	10015021W	10015021
Basic Drill Cage		●	●	●	●	●	●	●	●	●	●	●	●	●	●
Threaded + tapped base Large Window	90815075W	●		●		●									
Threaded + tapped base	90815075		●		●		●								
Threaded Mounting Base Large Window w/ Vacuum	90815078W									●		●		●	
Threaded Mounting Base Large Window w/ Vacuum	90815078										●		●		●
Offset Mounting Base Large Window + 3 nylon pins	90815084W							●							
Offset Mounting Base + 3 nylon pins	90815084								●						
Hard Chrome Steel Nose	90825015			●	●							●	●		
Nylon Nose Piece	90825020					●	●							●	●
Celeron Rotary Nose	90825210	●	●							●	●				



Ball-Type Microstop Cages for Hand Drilling Tools  
 RB 257

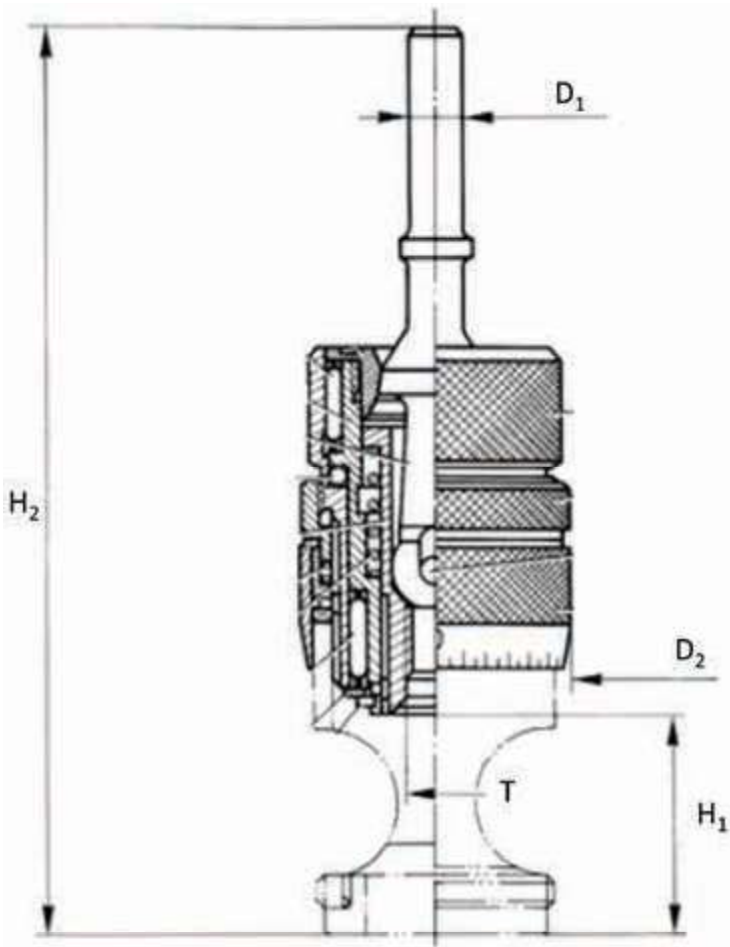

MICROSTOP CAGE									
				H1		H2		Stroke	
	T		D1	D2	Min	Max	Min	Max	
RB 257	M6 x 1	mm	6	29	19	24	88	92	6
		in	0.24	1.14	0.75	0.94	3.46	3.62	0.24

MOUNTING BASE								
		D1	D2	L1	L2	H2	R1	D6
90815075(W)	mm	NA	NA	NA	NA	31	NA	NA
	in	NA	NA	NA	NA	1.22	NA	NA
90815084(W)	mm	27	18	17.5	21	32	8	NA
	in	1.06	0.71	0.69	0.83	1.26	0.31	NA
90815078(W)	mm	NA	NA	NA	NA	31	NA	16
	in	NA	NA	NA	NA	1.22	NA	0.63

NOSE PIECE					
		D3	D4	H3	D7
90825210	mm	29	17	3	21.5
	in	1.14	0.67	0.12	0.85
90825015	mm	24	15	3	NA
90825010	in	0.94	0.59	0.12	NA
93045015	mm	5	NA	2	NA
	in	0.20	NA	0.08	NA

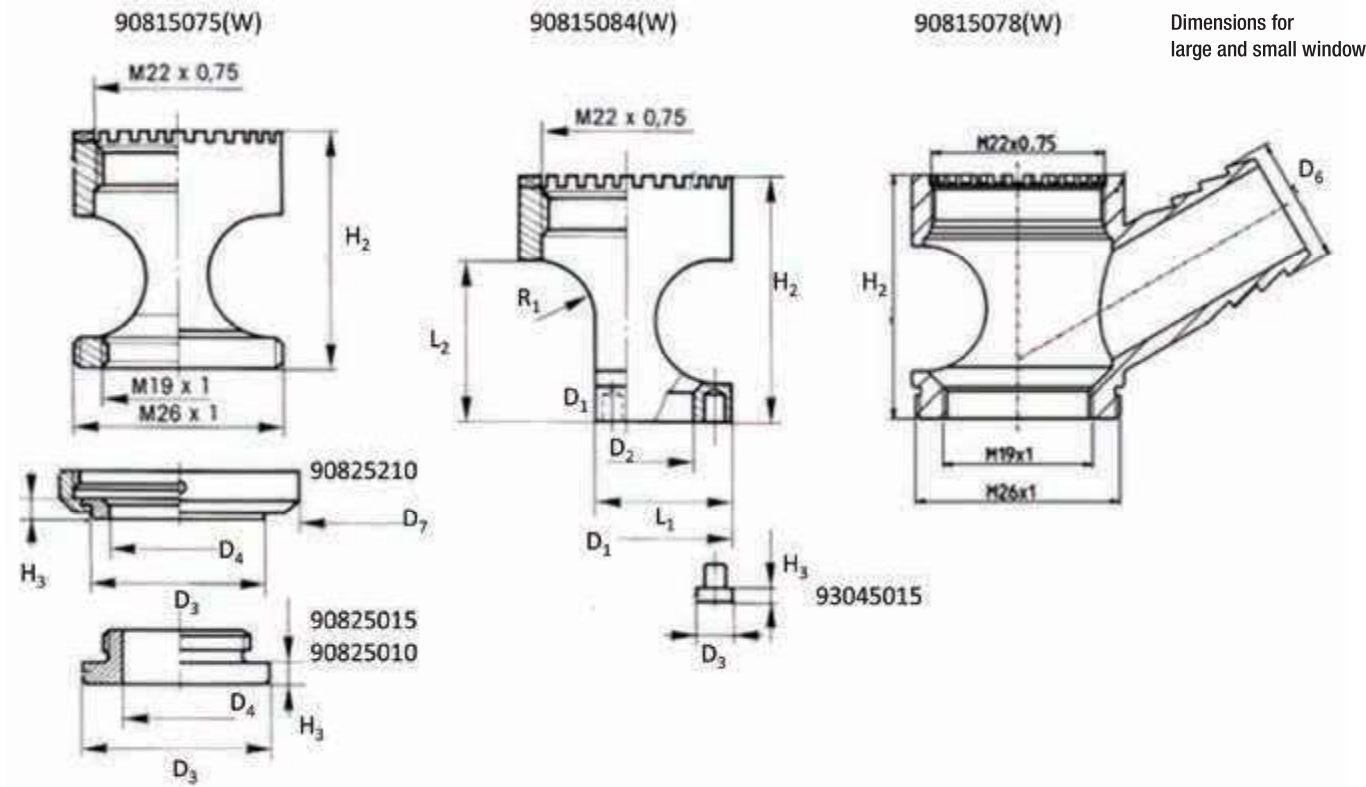

Ball-Type Microstop Cages for Hand Drilling Tools

RB 258 | RBI 258

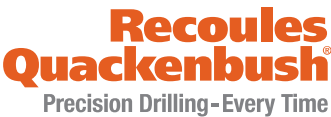

ADVANTAGES

- Different mounting bases available.
- Reduced dimensions for tight access areas.
- High precision microstop cage, body in heat-treated chrome steel, fully ground throughout. This ball-mounted microstop cage includes two needle bearings for best utilization.

PRECISION MANUFACTURING

- When using the RB 258, any misalignment of the microstop cage is corrected by the unique ball-pivoting spindle. This assembly ensures perpendicularity throughout the operation at all time.
- Centering cone of the cutter (120°) for perfect concentricity.
- Microstop depth adjustment (1 scale division = 0.001 in).
- Microstop depth setting is held securely in place by locknut with seal. This patented feature allows an easy loosening of the locknut without damage to the drill cage.



RB 258		MICROSTOP CAGE ASSEMBLY CODE	
		10015500PT	10015500W
RBI 258		10015550	10015550W
Basic Drill Cage		●	●
Mounting Base Large Window	90815077 W		●
Mounting Base	90815077	●	
Nose Piece	90825035	●	●

Ball-Type Microstop Cages for Hand Drilling Tools

RB 258 | RBI 258

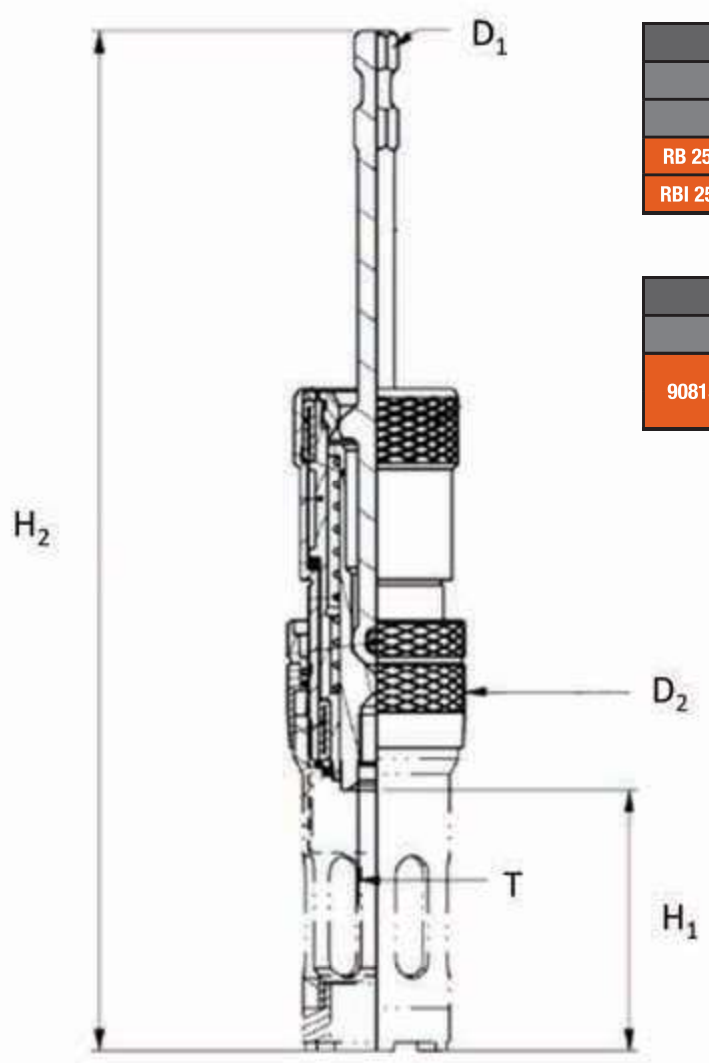

MICROSTOP CAGE									
					H1		H2		Stroke
	T		D1	D2	Min	Max	Min	Max	
RB 258	M6 x 1	mm	6.35	29	41	56	141	156	27
RBI 258	1/4 in - 28	in	0.25	1.14	1.61	2.20	5.55	6.14	1.06

MOUNTING BASE								
		D1	D2	L1	L2	H2	R1	D6
90815077(W)	mm	24	NA	NA	NA	49	NA	NA
	in	0.94	NA	NA	NA	1.93	NA	NA

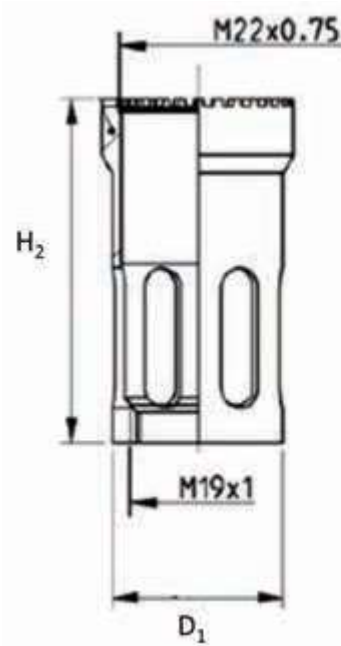

NOSE PIECE					
		D3	D4	H3	D7
90825935	mm	24	15	7	NA
	in	0.94	0.59	0.28	NA

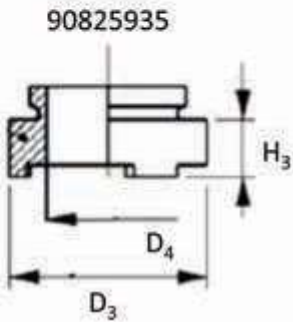

## Microstop Cages for Hand Drilling Tools

### RB 306 - Large Window

**Recoules  
Quackenbush®**  
Precision Drilling - Every Time

#### ADVANTAGES

- Different mounting bases available.
- This cage has been designed for use with cutters greater than 0.394 in dia.
- For special composites → mounting base with vacuum.

#### PRECISION MANUFACTURING

- Cemented, hardened, and ground chrome-nickel steel spindle mounted on a self-lubricating bronze body and a thrust bearing.
- Centering cone of the cutter (120°) for perfect concentricity.
- Microstop depth adjustment (1 scale division = 0.001 in).
- Microstop depth setting is held securely in place by locknut with seal. This patented feature allows an easy loosening of the locknut without damage to the drill cage.

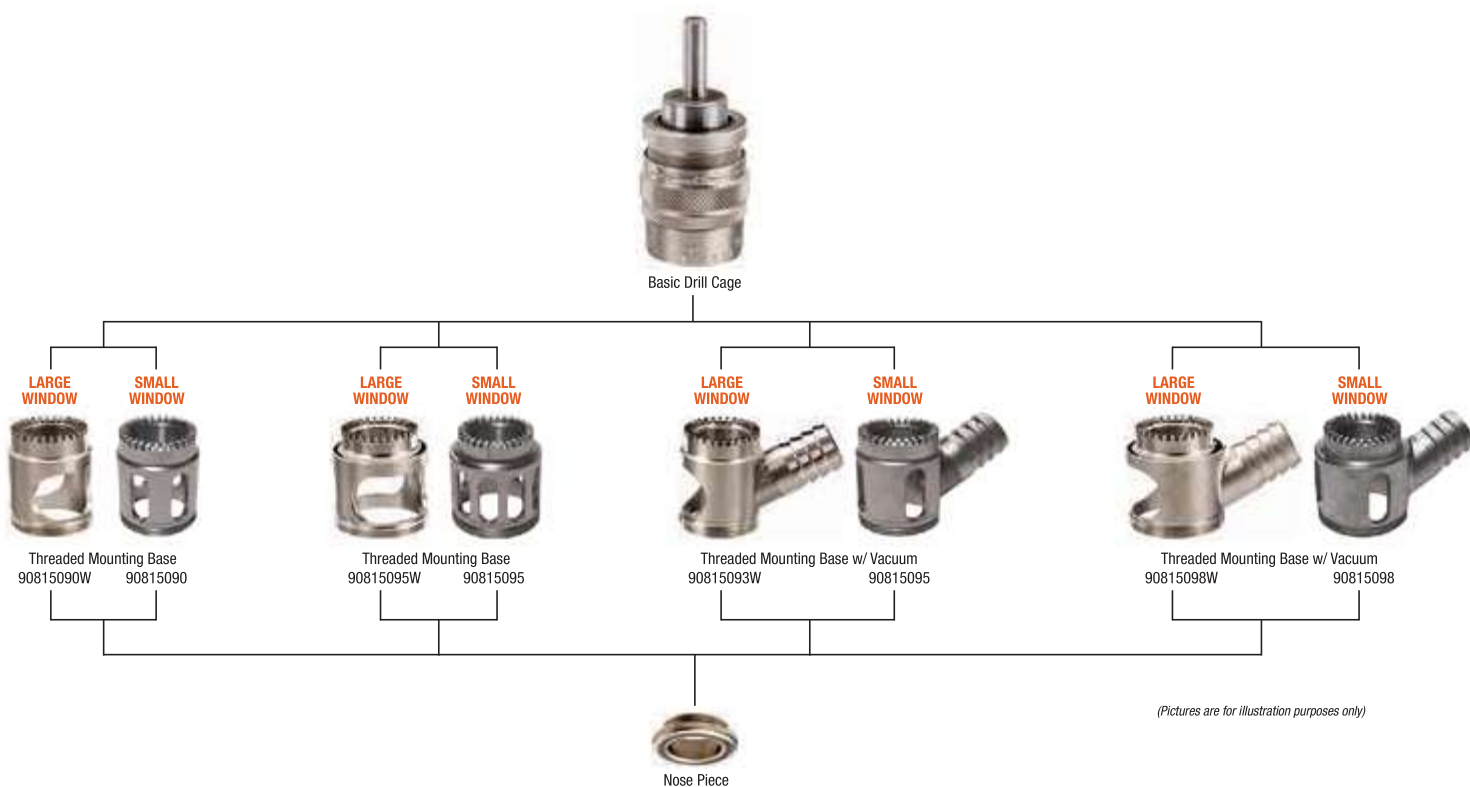

RB 306 - LARGE		MICROSTOP CAGE ASSEMBLY CODE: LARGE WINDOW								
		RC-10025010W	RC-10025015W	10025105W	10025110W	10025001W	10025016W	10025111W	10025116W	10025117W
Basic Drill Cage		●	●	●	●	●	●	●	●	●
Threaded Mounting Base Large Window	90815090W	●	●							
Threaded Mounting Base Large Window w/ Vacuum	90815093W					●	●			
Threaded Mounting Base Large Window	90815095W			●	●					
Threaded Mounting Base Large Window w/ Vacuum	90815098W							●	●	●
Hard Chrome Steel Nose	90825050	●				●				
Nylon Nose Piece	90825055		●				●			
Hard Chrome Steel Nose	90825080			●						●
Nylon Nose Piece	90825085				●			●		
Rotary Nose Piece	90825090								●	

# Microstop Cages for Hand Drilling Tools

## RB 306 - Small Window

**Recoles  
Quackenbush®**  
Precision Drilling-Every Time

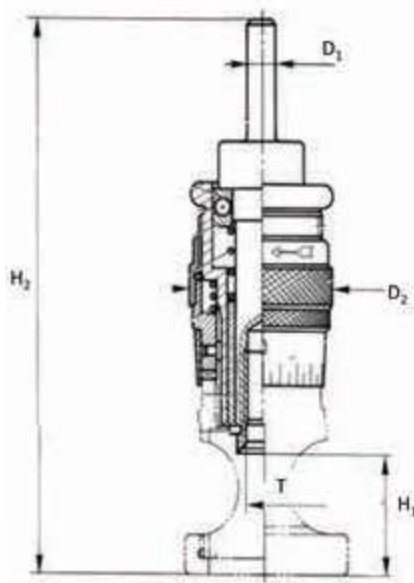

MICROSTOP CAGE									
				H1		H2		Stroke	
	T		D1	D2	Min	Max	Min	Max	
RB 306	M6 x 1	mm	6	28	19	26	91	98	7.5
		in	0.24	1.10	0.75	1.02	3.58	3.86	0.30

MOUNTING BASE								
		D1	D2	L1	L2	H2	R1	D6
90815090(W)	mm	NA	NA	NA	NA	32	NA	NA
	in	NA	NA	NA	NA	1.26	NA	NA
90815095(W)	mm	NA	NA	NA	NA	32	NA	NA
	in	NA	NA	NA	NA	1.26	NA	NA
90815093(W)	mm	NA	22	NA	NA	32	NA	16
	in	NA	0.87	NA	NA	1.26	NA	0.63
90815098(W)	mm	NA	26	NA	NA	32	NA	16
	in	NA	1.02	NA	NA	1.26	NA	0.63

Dimensions  
for large and  
small window

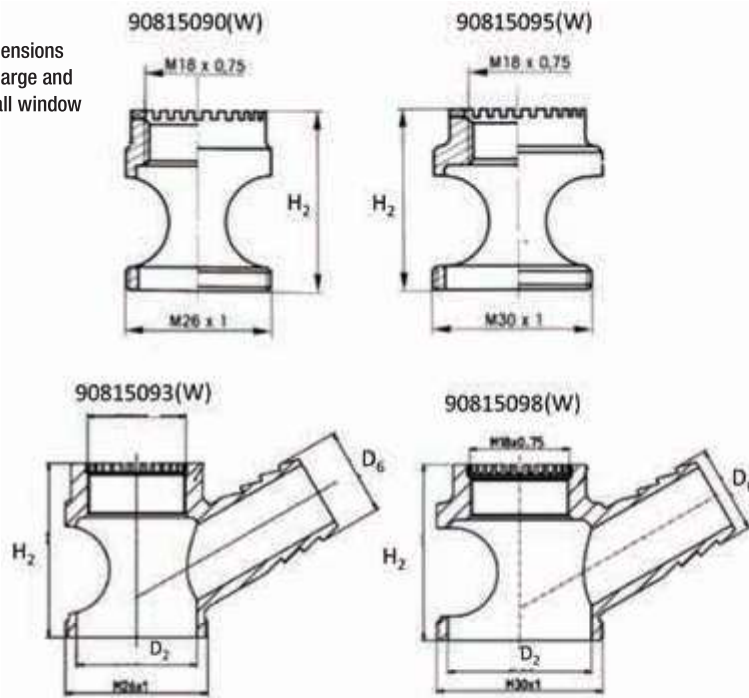

NOSE PIECE					
		D3	D4	H3	D7
90825050	mm	32	22	3	NA
90825055	in	1.26	0.87	0.12	NA
90825080	mm	36	26	3	NA
90825085	in	1.42	1.02	0.12	NA

RB 306 - SMALL		MICROSTOP CAGE ASSEMBLY CODE: SMALL WINDOW								
		RC-10025010	RC-10025015	10025105	10025110	10025001	10025016	10025111	10025116	10025117
Basic Drill Cage		●	●	●	●	●	●	●	●	●
Threaded Mounting Base	90815090	●	●							
Threaded Mounting Base w/ Vacuum	90815093					●	●			
Threaded Mounting Base	90815095			●	●					
Threaded Mounting Base w/ Vacuum	90815098						●	●	●	
Hard Chrome Steel Nose	90825050	●				●				
Nylon Nose Piece	90825055		●				●			
Hard Chrome Steel Nose	90825080			●						●
Nylon Nose Piece	90825085				●			●		
Rotary Nose Piece	90825090							●		

Ball-Type Microstop Cages for Hand Drilling Tools

RB 307 | RBI 307 - Large Window



ADVANTAGES

- Different mounting bases available.
- Reduced dimensions for tight access areas.
- For special composites → mounting base with vacuum.

PRECISION MANUFACTURING

- High precision microstop cage, body in heat-treated chrome steel, fully ground throughout. This ball-mounted microstop cage includes two needle bearings for best utilization.
- When using the RB 307, any misalignment of the microstop cage is corrected by the unique ball-pivoting spindle. This assembly ensures perpendicularity throughout the operation at all time.
- Centering cone of the cutter (120°) for perfect concentricity.
- Microstop depth adjustment (1 scale division = 0.001 in).
- Microstop depth setting is held securely in place by locknut with seal. This patented feature allows an easy loosening of the locknut without damage to the drill cage.

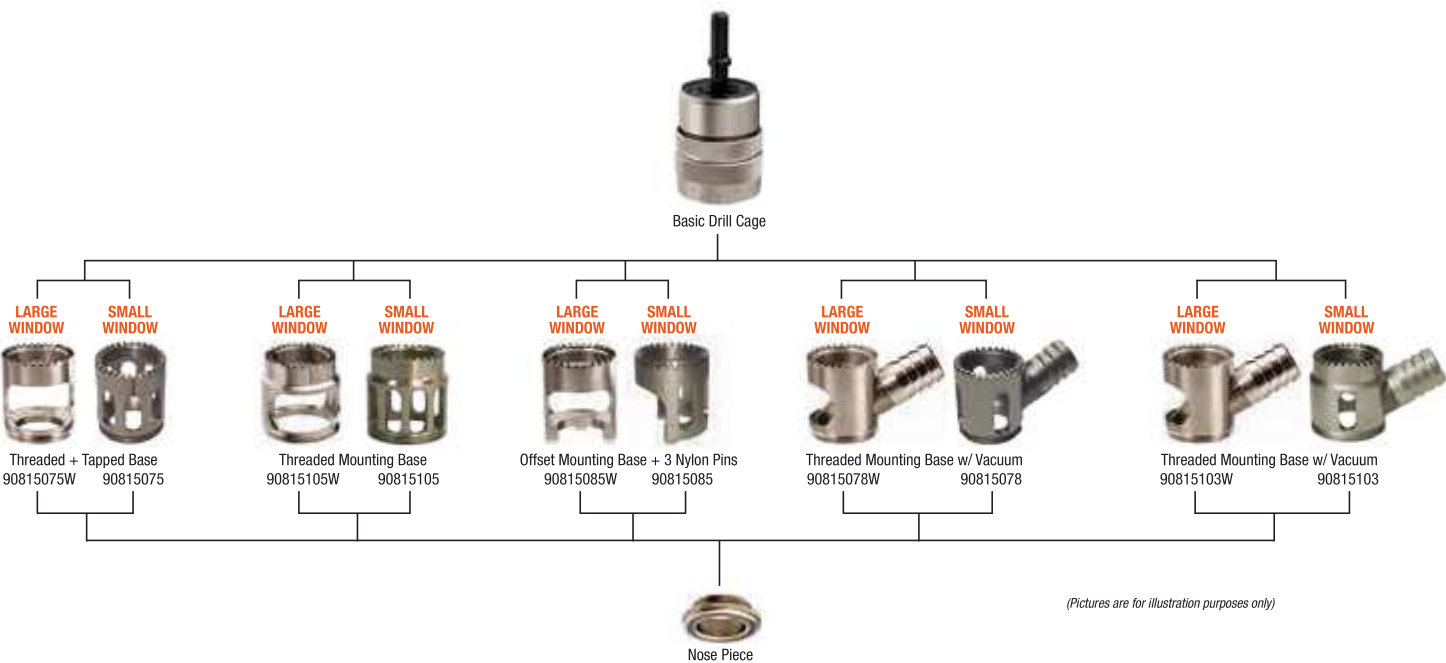

(Pictures are for illustration purposes only)

RB 307 - LARGE		MICROSTOP CAGE ASSEMBLY CODE: LARGE WINDOW												
		10020010W	10020015W	10020020W	10020105W	10020110W	10020115W	10020200W	10020016W	10020001W	10020021W	10020106W	10020111W	10020116W
RBI 307 - LARGE		10020060W	10020065W	10020070W	10020155W	10020160W	10020165W	10020250W						10020166W
Basic Drill Cage		●	●	●	●	●	●	●	●	●	●	●	●	●
Threaded + tapped base Large Window	90815075W	●	●	●										
Threaded Mounting Base Large Window w/ Vacuum	90815078W								●	●	●			
Offset Mounting Base Large Window + 3 nylon pins	90815085W							●						
Threaded Mounting Base Large Window w/ Vacuum	90815103W											●	●	●
Threaded Mounting Base Large Window	90815105W				●	●	●							
Nose Piece - Rotary Assembly	90825210	●								●				
Hard Chrome Steel Nose	90825015		●						●					
Nylon Nose Piece	90825020			●							●			
Celeron Rotary Nose	90825205				●							●		
Hard Chrome Steel Nose	90825080					●							●	
Nylon Nose Piece	90825085						●							●



# Ball-Type Microstop Cages for Hand Drilling Tools

RB 307 | RBI 307 - Small Window

**Recoles**  
**Quackenbush**  
Precision Drilling-Every Time

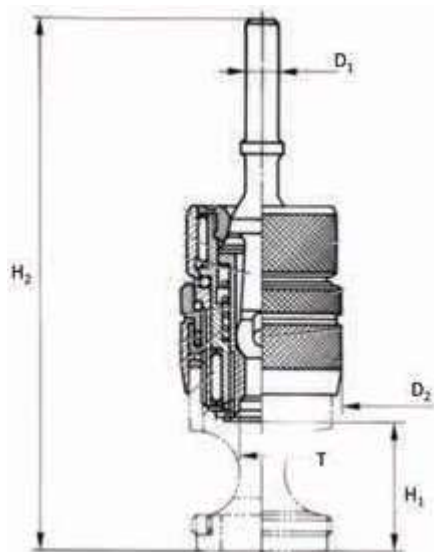

MICROSTOP CAGE									
	T		D1	D2	H1		H2		Stroke
					Min	Max	Min	Max	
RB 307	M8 x 1	mm	6	29	19	24	88	92	7.5
RBI 307	1/4 in - 28	in	0.24	1.14	0.75	0.94	3.46	3.62	0.30

MOUNTING BASE								
		D1	D2	L1	L2	H2	R1	D6
90815075(W)	mm	NA	NA	NA	NA	31	NA	NA
	in	NA	NA	NA	NA	1.22	NA	NA
90815105(W)	mm	NA	NA	NA	NA	31	NA	NA
	in	NA	NA	NA	NA	1.22	NA	NA
90815085(W)	mm	27	18	17.5	21	32	5	3
	in	1.06	0.71	0.69	0.83	1.26	0.20	0.12
90815078(W)	mm	NA	NA	NA	NA	31	NA	16
	in	NA	NA	NA	NA	1.22	NA	0.63
90815103(W)	mm	NA	24.5	NA	NA	30.5	NA	16
	in	NA	0.96	NA	NA	1.20	NA	0.63

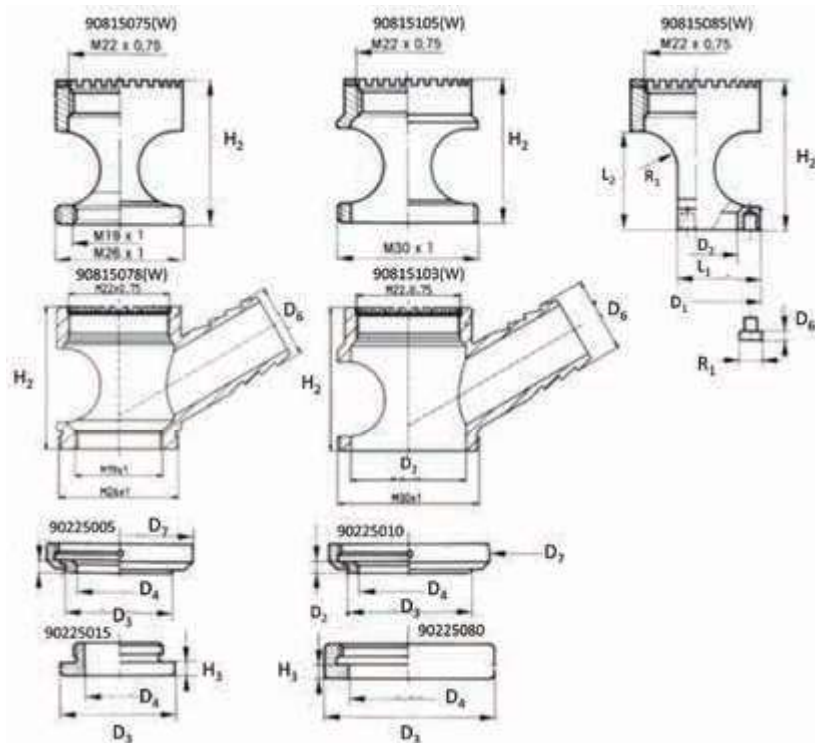

Dimensions for  
large and small window

NOSE PIECE					
		D3	D4	H3	D7
90225005	mm	21.5	17	3	29
	in	0.85	0.67	0.12	1.14
90225010	mm	26	23	3	34
	in	1.02	0.91	0.12	1.34
90225015	mm	24	15	3	NA
	in	0.94	0.59	0.12	NA
90225080	mm	36	26	3	NA
	in	1.42	1.02	0.12	NA

RB 307 - SMALL		MICROSTOP CAGE ASSEMBLY CODE: SMALL WINDOW												
		10020010	10020015	10020020PT	10020105	10020110	10020115	10020200	10020016	10020001	10020021	10020106	10020111	10020116
RBI 307 - SMALL		10020060	10020065	10020070	10020155	10020160	10020165	10020250						10020166
Basic Drill Cage		●	●	●	●	●	●	●	●	●	●	●	●	●
Threaded + tapped base	90815075	●	●	●										
Threaded Mounting Base w/ Vacuum	90815078								●	●	●			
Offset Mounting Base + 3 nylon pins	90815085							●						
Threaded Mounting Base w/ Vacuum	90815103											●	●	●
Threaded Mounting Base	90815105				●	●	●							
Celeron Rotary Nose	90825210	●								●				
Hard Chrome Steel Nose	90825015		●						●					
Nylon Nose Piece	90825020			●							●			
Celeron Rotary Nose	90825205				●									
Hard Chrome Steel Nose	90825080					●							●	
Nylon Nose Piece	90825085						●							●

## Microstop Cages for Hand Drilling Tools

RB 356 HP 21 | RBI 356 HPI 21 - Large Window

**Recoules  
Quackenbush**  
Precision Drilling - Every Time

### PRECISION MANUFACTURING

- Detachable spindle adapter provides alternative methods for use:
  - In combination with 3 jaw chuck.
  - Mounting direct onto machine spindle. This method provides increased level of concentricity, while reducing the length and weight of the drill/tool assembly. This results in better performance, improved machining and less fatigue on the operator.
- Cemented, hardened, and ground chrome-nickel steel spindle mounted on 3-needle-bearings and a thrust bearing.
- Microstop depth adjustment (1 scale division = 0.001 in).
- Microstop depth setting is held securely in place by locknut with seal. This patented feature allows an easy loosening of the locknut without damage to the drill cage.

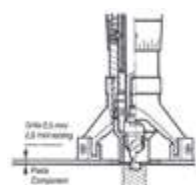

#### DRILLING + COUNTERSINKING APPLICATION

- The mounting base is commonly used with strip templates. The tripod ensures maximum stability. Can be used with Cutter type RB 018 - see page 88.

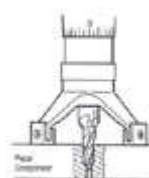

#### REAMING + COUNTERSINKING APPLICATION

- In this example, the tripod is used with cutter RB 022 - see page 91. (Positioning of the cutter with pilot into the pilot hole).

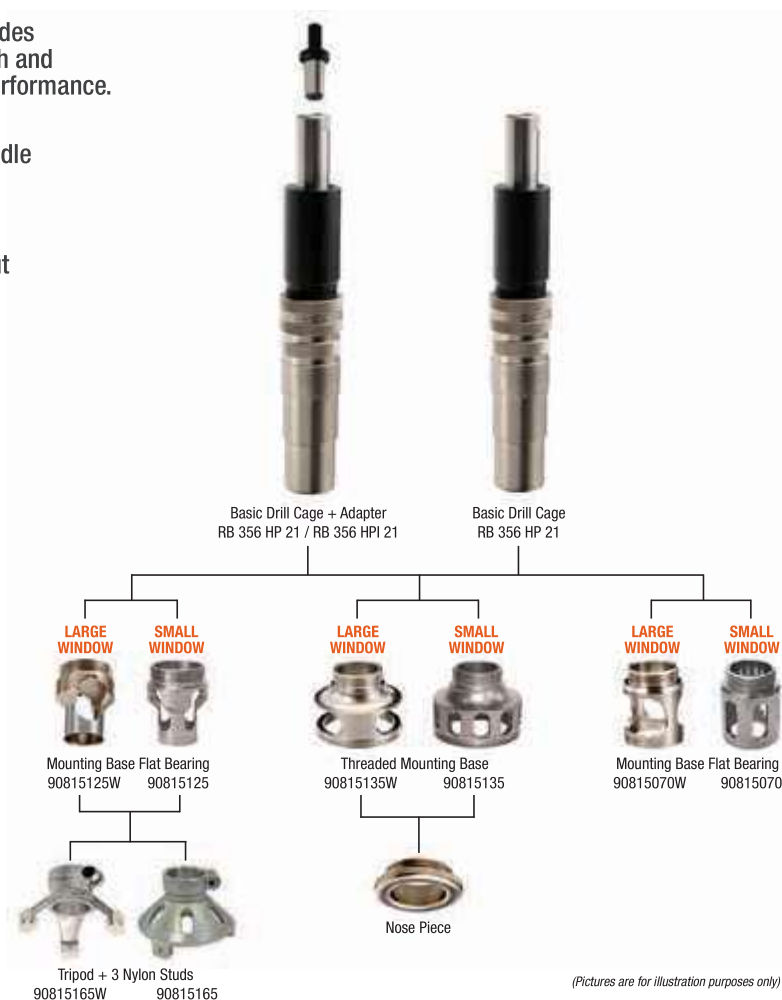

RB 356 HP 21 - LARGE		MICROSTOP CAGE ASSEMBLY CODE: LARGE WINDOW*					
		10040000PT	10040200W	10040210W	10040405W	10040505W	10040600W
RB 356 HPI 21 - LARGE		10040050	10040250W	10040260W	10040455W	10040555W	10040650W
RB 356 HPI 21 (Thread 3/8 - 24F)		10040700PT	10040720W	10040730W	10040740W	10040750W	10040760W
Basic Drill Cage + Adapter	RB 356 HP 21 RB 356 HPI 21	●	●	●	●	●	●
Mounting Base Flat Bearing Large Window	90815125W		●	●			
Threaded Mounting Base Large Window	90815135W				●		
Tripod + 3 nylon studs	90815165W			●		●	
Mounting Base Flat Bearing Large Window	90815070W						●
Nylon Nose Piece	90825175				●		

\*Add CJ or CJW to the reference for Jacobs cone adapter.

## Microstop Cages for Hand Drilling Tools

RB 356 HP 21 | RBI 356 HPI 21 - Small Window

**Recoles  
Quackenbush®**  
Precision Drilling - Every Time

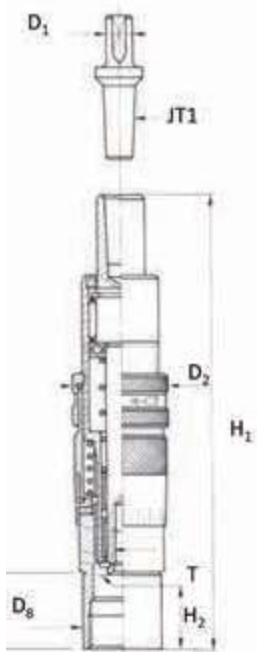

MICROSTOP CAGE										
	T		D1	D2	H1		H2		Stroke	D8
					Min	Max	Min	Max		
RB 356 HP 21	M6 x 1	mm	7	27	4	24	116	136	21	22
RB 356 HPI 21	1/4 in - 28	in	0.28	1.06	0.16	0.94	4.57	5.35	0.83	0.87

MOUNTING BASE								
		D1	D2	L1	L2	H2	R1	D6
90815125(W)	mm	14.5	12.5	22	NA	26	NA	NA
	in	0.57	0.49	0.87	NA	1.02	NA	NA
90815135(W)	mm	NA	NA	21	NA	27	NA	NA
	in	NA	NA	0.83	NA	1.06	NA	NA
90815070(W)	mm	24	19	24	NA	30	NA	NA
	in	0.94	0.75	0.94	NA	1.18	NA	NA
90815165(W)	mm	64	51	6.5	2	42	NA	22
	in	2.52	2.01	0.26	NA	1.65	NA	0.87

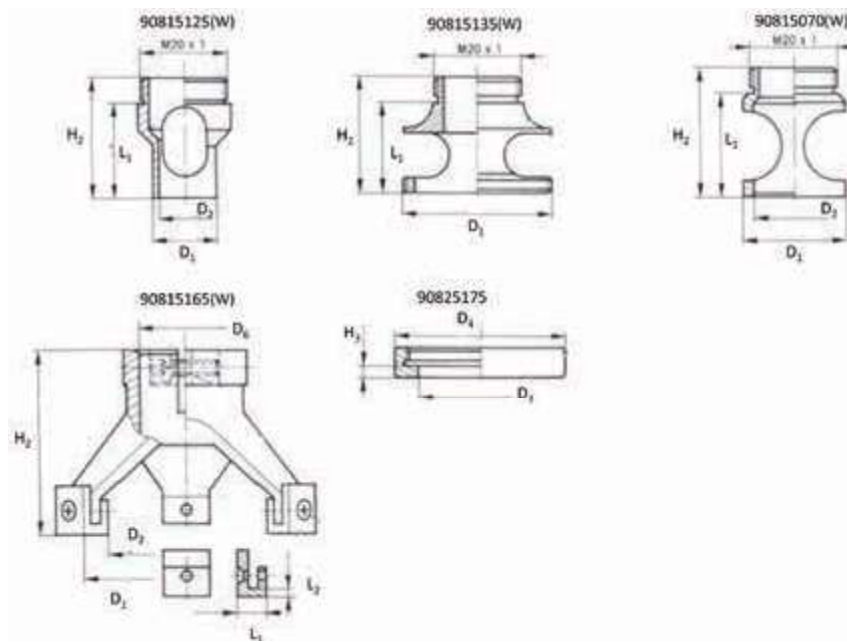

Dimensions for  
large and small window

NOSE PIECE					
		D3	D4	H3	D7
90825175	mm	29	40	3	NA
	in	1.14	1.57	0.12	NA

RB 356 HP 21 - SMALL		MICROSTOP CAGE ASSEMBLY CODE: SMALL WINDOW*					
		1004000PT	10040200PT	10040210	10040405	10040505	10040600PT
RB 356 HPI 21 - SMALL		10040050	10040250	10040260	10040455	10040555	10040650
RB 356 HPI 21 (Thread 3/8 - 24F)		10040700PT	10040720	10040730	10040740	10040750	10040760
Basic Drill Cage + Adapter	RB 356 HP 21 RB 356 HPI 21	●	●	●	●	●	●
Mounting Base Flat Bearing	90815125		●	●			
Threaded Mounting Base	90815135				●		
Tripod + 3 Nylon studs	90815165			●		●	
Mounting Base Flat Bearing	90815070						●
Nylon Nose Piece	90825175				●		

\*Add CJ or CJW to the reference for Jacobs cone adapter.

## Microstop Cages for Hand Drilling Tools

RB 356 HP 38 | RBI 356 HPI 38 - Large Window

**Recoules Quackenbush**  
Precision Drilling - Every Time

### PRECISION MANUFACTURING

- Detachable spindle adapter provides alternative methods for use:
  - In combination with 3 jaw chuck.
  - Mounting direct onto machine spindle. This method provides increased level of concentricity, while reducing the length and weight of the drill/tool assembly. This results in better performance, improved machining and less fatigue on the operator.
- Cemented, hardened, and ground chrome-nickel steel spindle mounted on 3-needle-bearings and a thrust bearing.
- Microstop depth adjustment (1 scale division = 0.001 in).
- Microstop depth setting is held securely in place by locknut with seal. This patented feature allows an easy loosening of the locknut without damage to the drill cage.

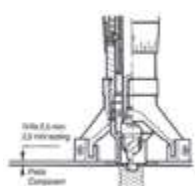

#### DRILLING + COUNTERSINKING APPLICATION

- The mounting base is commonly used with strip templates. The tripod ensures maximum stability. Can be used with Cutter type RB 018 - see page 88.

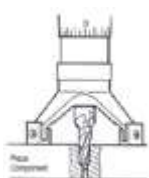

#### REAMING + COUNTERSINKING APPLICATION

- In this example, the tripod is used with cutter RB 022 - see page 91. (Positioning of the cutter with pilot into the pilot hole).

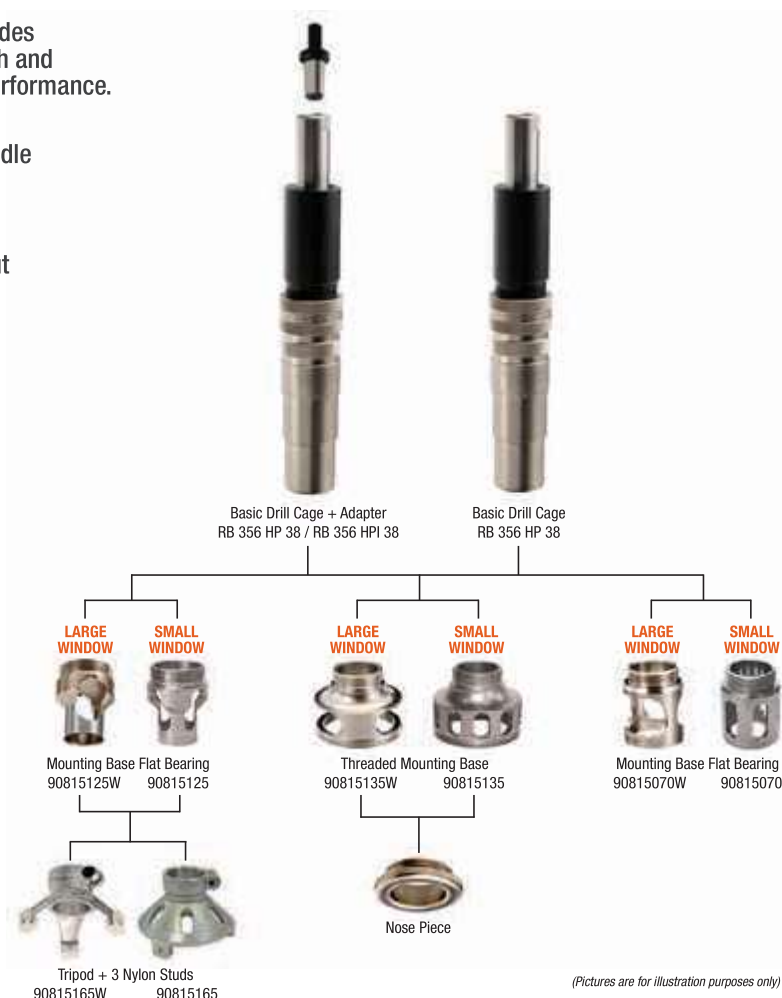

(Pictures are for illustration purposes only)

RB 356 HP 38 - LARGE		MICROSTOP CAGE ASSEMBLY CODE: LARGE WINDOW*					
		10045000PT	10045200W	10045210W	10045405W	10045505W	10045600W
RB 356 HPI 38 - LARGE		10045050	10045250W	10045260W	10045455W	10045555W	10045650W
RB 356 HPI 38 (Thread 3/8 - 24F)		10045700PT	10045720W	10045730W	10045740W	10045750W	10045760W
Basic Drill Cage + Adapter	RB 356 HP 38 RB 356 HPI 38	●	●	●	●	●	●
Mounting Base Flat Bearing Large Window	90815125W		●	●			
Threaded Mounting Base Large Window	90815135W				●		
Tripod + 3 nylon studs	90815165W			●		●	
Mounting Base Flat Bearing Large Window	90815070W						●
Nylon Nose Piece	90825175				●		

\*Add CJ or CJW to the reference for Jacobs cone adapter.

## Microstop Cages for Hand Drilling Tools

RB 356 HP 38 | RBI 356 HPI 38 - Small Window

**Recoles  
Quackenbush**  
Precision Drilling - Every Time

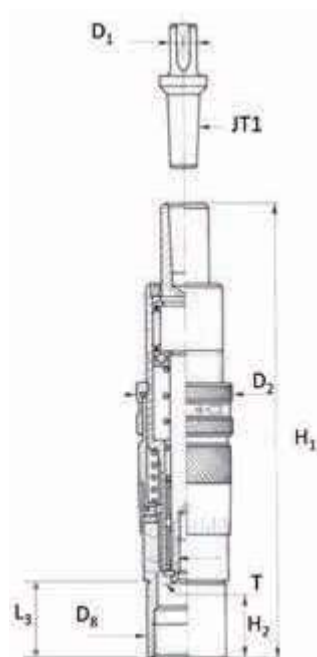

MICROSTOP CAGE											
	T		D1	D2	H1		H2		Stroke	D8	L3
					Min	Max	Min	Max			
RB 356 HP 38	M6 x 1	mm	7	27	22	37	165	183	38	22	22
RB 356 HPI 28	1/4 in - 28	in	0.28	1.06	0.87	1.46	6.50	7.20	1.50	0.87	0.87

MOUNTING BASE								
		D1	D2	L1	L2	H2	R1	D6
90815125(W)	mm	14.5	12.5	22	NA	26	NA	NA
	in	0.57	0.49	0.87	NA	1.02	NA	NA
90815135(W)	mm	NA	NA	21	NA	27	NA	NA
	in	NA	NA	0.83	NA	1.06	NA	NA
90815070(W)	mm	24	19	24	NA	30	NA	NA
	in	0.94	0.75	0.94	NA	1.18	NA	NA
90815165(W)	mm	64	51	6.5	2	42	NA	22
	in	2.52	2.01	0.26	NA	1.65	NA	0.87

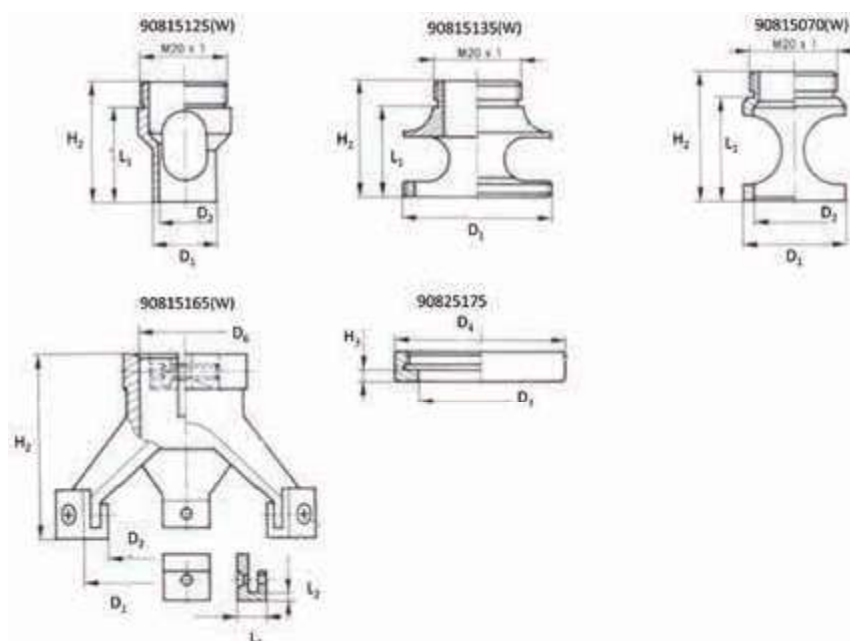

Dimensions for  
large and small window

NOSE PIECE					
		D3	D4	H3	D7
90825175	mm	29	40	3	NA
	in	1.14	1.57	0.12	NA

RB 356 HP 38 - SMALL		MICROSTOP CAGE ASSEMBLY CODE: SMALL WINDOW*					
		10045000PT	10045200PT	10045210	10045405	10045505	10045600PT
RB 356 HPI 38 - SMALL		10045050	10045250	10045260	10045455	10045555	10045650
RB 356 HPI 38 (Thread 3/8 - 24F)		10045700PT	10045720	10045730	10045740	10045750	10045760
Basic Drill Cage + Adapter	RB 356 HP 38 RB 356 HPI 38	●	●	●	●	●	●
Mounting Base Flat Bearing	90815125		●	●			
Threaded Mounting Base	90815135				●		
Tripod + 3 Nylon studs	90815165			●		●	
Mounting Base Flat Bearing	90815070						●
Nylon Nose Piece	90825175				●		

\*Add CJ or CJW to the reference for Jacobs cone adapter.

Microstop Cages for Hand Drilling Tools

RB 356 HP 58 | RBI 356 HPI 58



ADVANTAGES

- Special for drill countersinking reamers and taper-lok cutters:
- - RB 356 HPI 58 for use with taper-lok cutters
- - RB 356 HP 58 for use with cutters RB 022

PRECISION MANUFACTURING

- Detachable spindle adapter provides alternative methods for use:
  - In combination with 3 jaw chuck.
  - Mounting direct onto machine spindle. This method provides increased level of concentricity, while reducing the length and weight of the drill / tool assembly. This results in better performance, improved machining, and less fatigue on the operator.
- Cemented, hardened, and ground chrome-nickel steel spindle mounted on 3 needle-bearings and a thrust bearing.
- Microstop depth adjustment (1 scale division = 0.001 in).
- Microstop depth setting is held securely in place by locknut with seal. This patented feature allows an easy loosening of the locknut without damage to the drill cage.



Basic Drill Cage + Adapter  
RB 356 HP 58 / RB 356 HPI 58



Mounting Base Flat Bearing  
90815140W



Mounting Base Flat Bearing  
90815140

(Pictures are for illustration purposes only)

RB 356 HP 58		MICROSTOP CAGE ASSEMBLY CODE*	
		10050000W	10050000
RB 356 HPI 58		10050050W	10050050
Basic Drill Cage + Adapter		●	●
Mounting Base Large Window	90815140W	●	
Mounting Base Flat Bearing	90815140		●

\*Add CJ or CJW to the reference for Jacobs cone adapter.



Microstop Cages for Hand Drilling Tools

RB 356 HP 58 | RBI 356 HPI 58

MICROSTOP CAGE												
				H1		H2						
	T		D1	D2	Min	Max	Min	Max	Stroke	D3	L3	D4
RB 356 HP 58	M10 x 1	mm	10	36	64	92	264	292	58	30	103	38
RB 356 HPI 58	7/16 in - 20	in	0.39	1.42	2.52	3.62	10.39	11.50	2.28	1.18	4.06	1.50

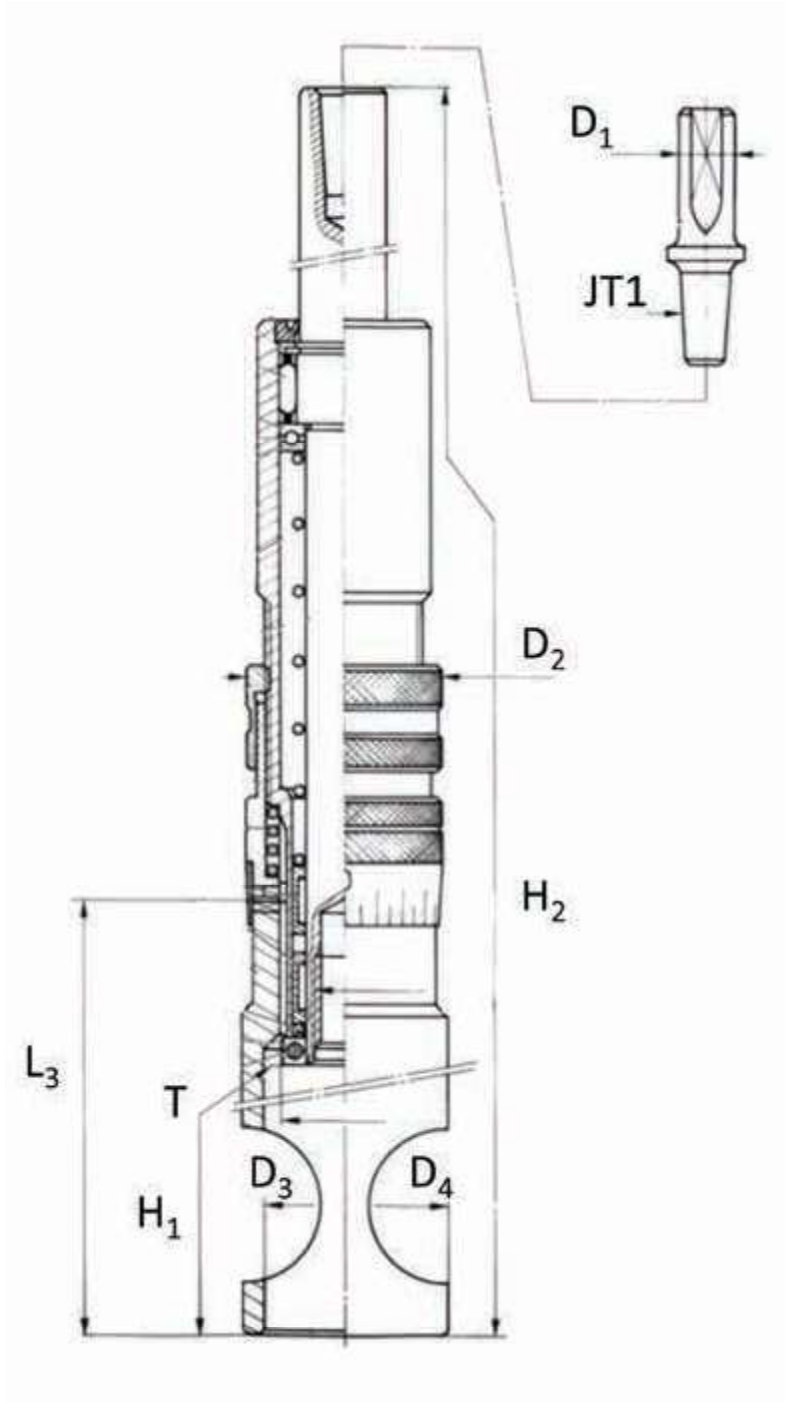

### ADVANTAGES

- This drill cage has been designed for use with cutter of 7/8 in to 1 1/2 in diameter.
- Different mounting bases available.
- Reduced dimensions for tight access areas.

### PRECISION MANUFACTURING

- Detachable spindle adapter provides alternative methods for use:
  - In combination with 3 jaw chuck.
  - Mounting direct onto machine spindle. This method provides increased level of concentricity, while reducing the length and weight of the drill/tool assembly. This results in better performance, improved machining, and less fatigue on the operator.
- Cemented, hardened, and ground chrome-nickel steel spindle mounted on 3-needle bearings and a thrust bearing.
- Microstop depth adjustment (1 scale division = 0.001 in).
- Microstop depth setting is held securely in place by locknut with seal. This patented feature allows an easy loosening of the locknut without damage to the drill cage.



RB 406		MICROSTOP CAGE ASSEMBLY CODE*			
		10030010W	10030010PT	100300105W	100300105
Basic Drill Cage + Adapter		●	●	●	●
Mounting Base Flat Bearing Large Window	90815150W	●			
Mounting Base Flat Bearing	90815150		●		
Mounting Base Flat Bearing Large Window	90815155W			●	
Mounting Base Flat Bearing	90815155				●

\*Add CJ or CJW to the reference for Jacobs cone adapter.

Microstop Cages for Hand Drilling Tools

RB 406

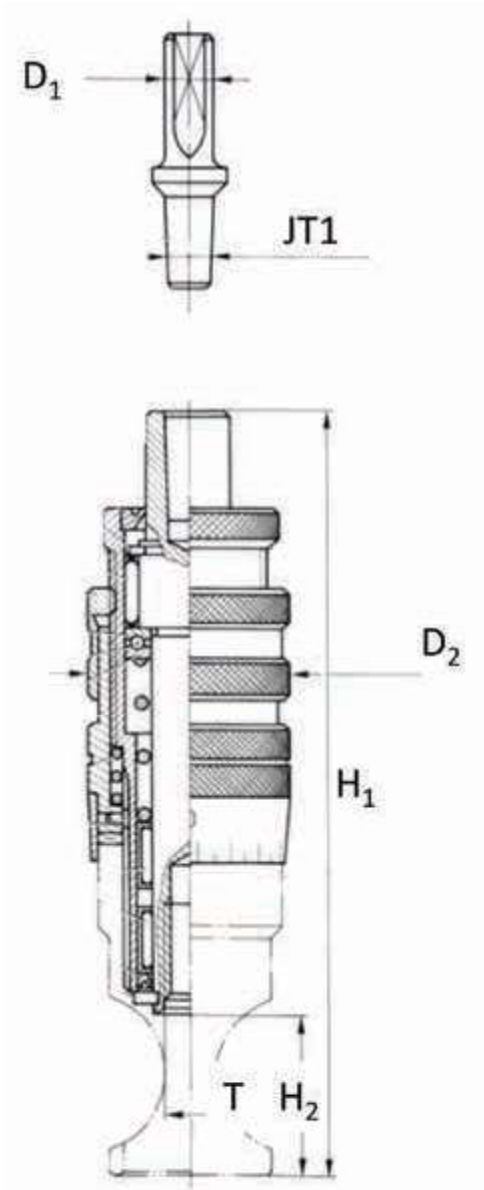

MICROSTOP CAGE									
					H1		H2		Stroke
	T		D1	D2	Min	Max	Min	Max	
RB406	M10 x 1	mm	10	36	26	53	136	163	14
		in	0.39	1.42	1.02	2.09	5.35	6.42	0.55

MOUNTING BASE								
		D1	D2	L1	L2	H2	R1	D6
90815150(W)	mm	30	25	NA	NA	63	NA	NA
	in	1.18	0.98	NA	NA	2.48	NA	NA
90815155(W)	mm	45	40	NA	NA	63	NA	NA
	in	1.77	1.57	NA	NA	2.48	NA	NA

Dimensions for  
large and small window

